



DAVIS-STANDARD®

Where your ideas take shape.



Elastomer

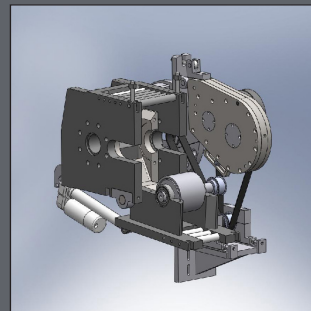
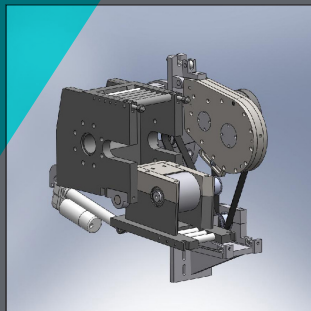
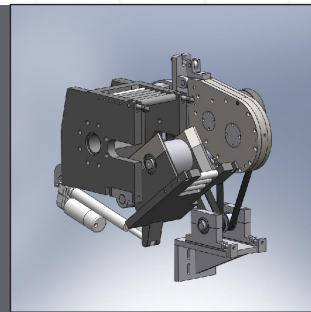
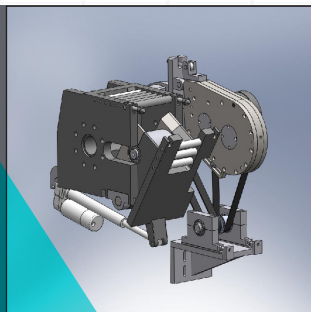

Elastomer Hinge-Roll Feedsection

Overview

The newly developed Davis-Standard Hinge-Roll feedsection was designed to benefit medical silicone processors and other processors who require frequent compound changes or cleaning of the feedroll. Loosening of two simple swing bolts allows cleaning access to the feedroll and inside of the feedsection by a swing-down feedroll cartridge that remains fixed to the feedsection. Removal of four additional fasteners allows complete removal and replacement of the feedroll and bearings.

Features

- Easy access to feedroll via two easily-accessible swing bolts.
- Reduced maintenance time for cleaning of feedroll.
- Belt drive eliminates lubrication requirements.
- Belts automatically loosen for removal of feedroll.
- Feedroll and bearings may be removed without disassembly of additional components.

Elastomer Hinge-Roll Feedsection

Advantages

- Easy access to feedroll via two easily- accessible swing bolts.
- Reduced maintenance time for cleaning of feedroll.
- Easy access to scraper adjustment.
- Belt drive eliminates lubrication requirements.
- Belts automatically loosen for removal of feedroll.
- Feedroll and bearings may be removed without disassembly of additional components.
- Feedroll retainer swings away from operator for safest operation and easy access for cleaning or complete removal of roll and bearing assembly.
- Includes advantages of the Davis-Standard adjustable torque clutch design:
 - Provides uniform, consistent feed rate.
 - Automatically compensates for feed strip size variation.
 - No external drive or motor required.
 - Compact arrangement of all drive components that are “purpose built and designed” for feeding strip rubber
 - Through-hardened steel scraper or optional nylon scraper for silicone applications.
- Available for retrofit to existing 3.5” Davis-Standard extruders. Other sizes to follow – consult Davis-Standard.

Available Options

- Chrome-plated feedsection and feedroll
- Nylon scraper
- Water-cooled feedroll

