

# LIQUID COATING & LAMINATING

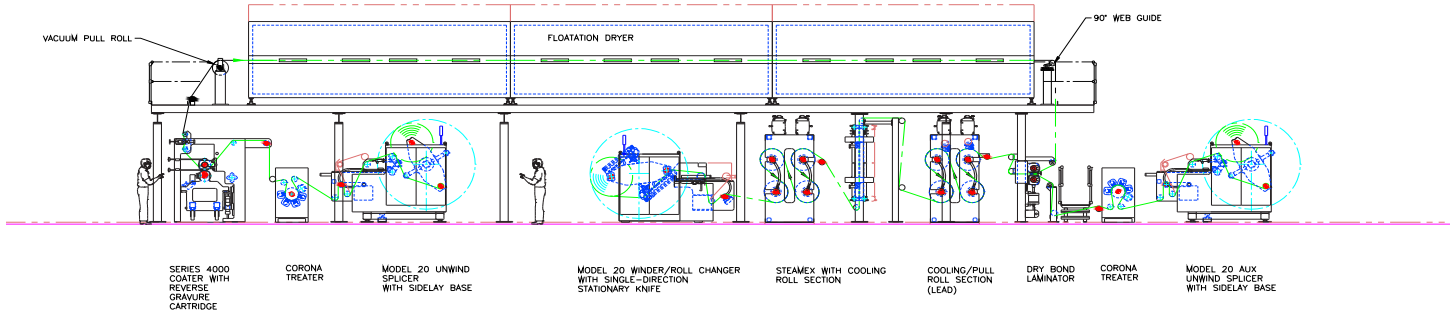

## PS COATING LINE

### OVERVIEW

The Davis-Standard Pressure Sensitive line uses the versatility of our Series 4000 Cartridge Coater, advanced drying technology, state-of-the-art Steamex and renowned winding technology to ensure converters run faster and still produce the highest quality pressure sensitive product possible. This process is available for testing and evaluation at our Research and Technical Center in Fulton, NY.

### DESIGN FEATURES

- Dual-Direction Turret Unwind / Splicer
- Series 4000 Cartridge Coater with a Reverse Gravure Cartridge
- Advanced Dryer Technology
- Steamex Rehumidification System
- Single-Direction Turret Winder / Roll Changer
- Integrator PRO Supervisory Control System
- AC Vector Drives for Greater Control Range and Less Maintenance

### COATING SPECIFICATIONS

	Coatweight	% Solids	Viscosity
Solvent-Based	2-70 lbs / 3000 sq ft (.9-31.8 kg / 279 sq m)	16 - 50%	100 - 30000 cps
Solvent-Based Typical	6-48 lbs / 3000 sq ft (2.7-21.7 kg / 279 sq m)	30 - 50%	100 - 30000 cps
Water-Based	1-20 lbs / 3000 sq ft (.45-9.0 kg / 279 sq m)	20 - 60%	100 - 6000 cps
Water-Based Typical	4-16 lbs / 3000 sq ft (1.8-7.3 kg / 279 sq m)	50 - 60%	100 - 2000 cps

# PS COATING LINE

## STANDARD FEATURES

- Dual-Direction Turret Unwind / Splicer
- Web Guide
- Corona Treater / Pull Roll
- Reverse Gravure Cartridge Coater
- Coating Supply System
- Integral Flotation System
- 90 Degree Web Guide
- Cooling Roll Section
- Auxiliary Dual-Direction Turret Unwind / Splicer
- Laminator
- Water Recirculation
- Steamex Rehumidification System
- Single-Direction Turret Winder / Roll Changer
- Patented Stationary Knife
- AC Vector Drives
- Integrator PRO Supervisory Control System
- Standard Offerings:
  - 48" Roll Face (30" - 42" Web)
  - 72" Roll Face (42" - 66" Web)
  - 96" Roll Face (66" - 90" Web)

## OPTIONAL FEATURES

- Custom Design Dryer
- Dryer Cooling Zone
- Solvent Coating Design
- Coater Enclosure
- Oxidizer
- Suction Roll
- Beta Gauge System
- Dual-Direction Turret Winder / Roll Changer
- In-line Slitting
- Ozone Decomposer
- Single Position Unwinds / Rewind (Shown Below)
- Alternative Coater Cartridges:
  - Dual Rod Cartridge
  - Flex Bar Cartridge
  - Direct or Indirect Die Cartridge
  - Pressurized Gravure Head (PGH) Cartridge
  - Reverse Roll Cartridge (Nip, Fountain or Pan Fed)

## MACHINE DATA

- Roll Face: 96 inches maximum
- Web Width: up to 90 inches (2286 mm)
- Substrates: Paper 30-200 lbs. / 3000 sq. ft. assorted films
- Line Speed: up to 1500 fpm (457.2 mpm) (tailored to process)
- Tension Range: up to 240 lbs. (109 kg)
- Dryer Length: (tailored to process)

